

P.U.Z. "SUPERMAGAZIN, RACORDURI UTILITATI SI IMPREJMUIRE TEREN"

STR. CONSTANTIN PLATON NR.14, MUN. BACAU
SAFTIUC CORNELIU SI SLIC MIHAI IULIAN

4 - REGLEMENTARI ECHIPARE EDILITARA

Parcela (PUZ)			
Nr. Pct.	Coordonate pct.de contur	Lungimi latari	D(i,i+1)
1	568012.568 648018.757	159.478	62.653
2	567853.090 648018.505	62.653	104.375
3	567852.165 647956.859	104.375	46.327
4	567853.579 647851.494	46.327	156.492
5	567856.043 647805.233	156.492	213.524
6	568012.535 647805.233	213.524	

S(PUZ)=34.000mp P=742.949m

Parcela (Beneficiar)			
Nr. Pct.	Coordonate pct.de contur		Lungimi latari
	X [m]	Y [m]	
1	568001.170	647834.110	56.147
2	568001.062	647890.257	12.530
12	568001.038	647902.787	118.498
13	567882.540	647902.787	12.531
3	567882.404	647890.257	33.066
4	567882.045	647857.193	14.921
5	567882.581	647842.282	25.000
6	567907.565	647843.181	14.508
7	567908.086	647828.662	5.743
8	567913.771	647829.493	25.964
9	567939.526	647832.783	21.165
10	567960.587	647834.874	22.470
11	567983.015	647836.247	18.280

S(Total)=8000mp P=380.823m

VIZAT :
O.C.P.I. BACAU

567900

567900

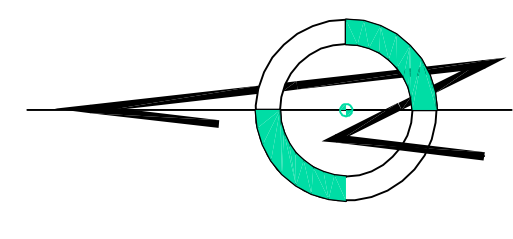

LEGENDA

- LIMITA ZONA STUDIATA
- LIMITA INCINTA BENEFICIAR
- CONSTRUCTII PROPUSE
- ZONA CIRCULATIE CAROSABILA
- ZONA CIRCULATIE PIETONALA (TROTOARE)
- ZONA PARCAJE CU DALE INIERBATE
- ZONA VERDE PROTECTIE
 - CP
 - BV
 - R
 - SP
 - GE
 - PG
- RETEA APA EXISTENTA
- RETEA APA PROPUSA
- COLECTOR CANALIZARE EXISTENT
- COLECTOR CANALIZARE PROPUSA
- RETEA GAZE PRESIUNE REDUSA EXISTENTA
- RETEA GAZE PRESIUNE REDUSA PROPUSA
- CAMIN APOMETRU PROPUS
- HIDRANT SUBTERAN DE INCENDIU PROPUS
- POST REGLARE MASURA PROPUS

567900

Nota:
Coordonatele X, Y - STEREO 70
Cota Z - Plan de referinta Marea Neagra



S.C. "RESMIN" S.R.L. - J04/2829/1992

Elaboratori	Numele	Scara	Beneficiar
Proiectat	Ing. Gheorghiada Adriana	1 : 500	SAFTIUC CORNELIU
Pr.asistata	Cerbu Maria		SLIC MIHAI IULIAN
Sef proiect	Arh. Anghel Teodor	Data:	REGLEMENTARI
Director	Ing. Balan Corneliu	2012	ECHIPARE EDILITARA

Titlu proiect: "SUPERMAGAZIN RACORDURI UTILITATI SI IMPREJMUIRE TEREN"

Amplasament: Str. Constantin Platon nr.14, Mun. Bacau, Judetul Bacau

Proiect nr. 9 / 2012

Faza: P.U.Z.

Planşa nr. U - 4

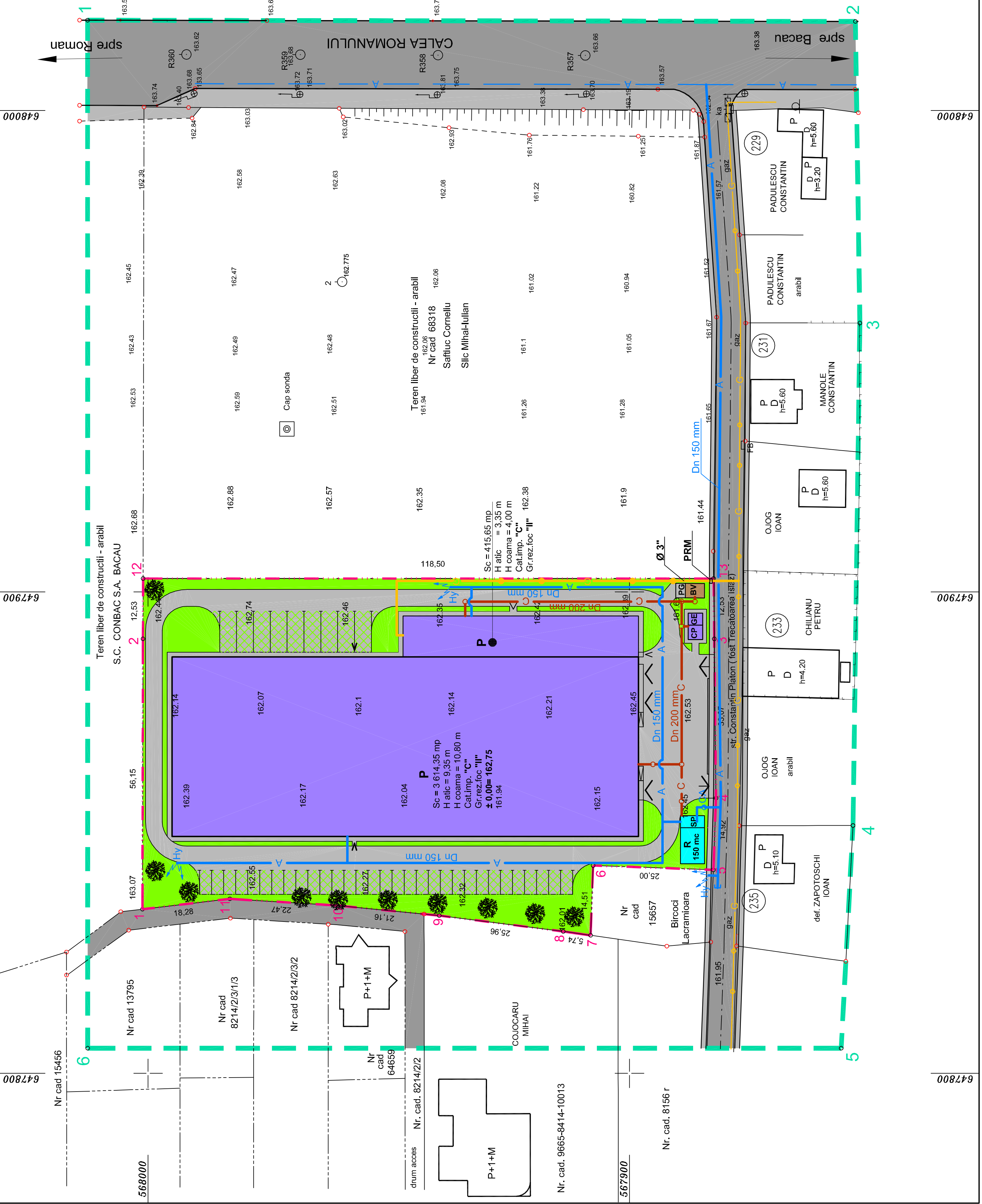

647900

647900

647800